

# Product Information

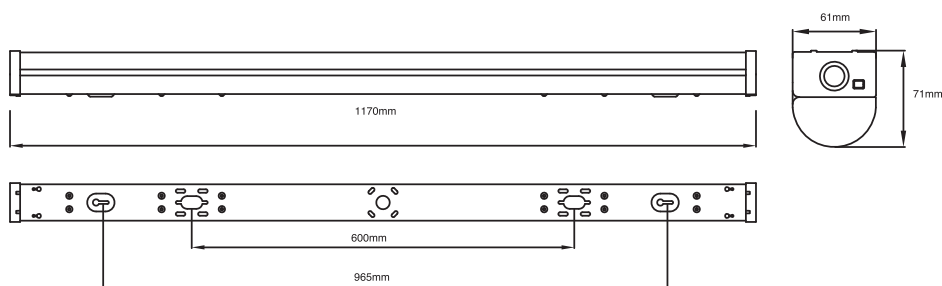

## Technical Specifications

Model	Voltage	Power	Lumen (±5%)	Lumen per Watt	Energy Efficiency Class	Power Factor	Beam angle	CCT	Lifespan	CRI	Dimmable	Dimension
S30132	AC 220-240V	20/26/30/37W	3000/3900/4500/5500	150lm/W	C	>0.9	120°	3000K/4000K/6500K	50000h	>80	No	1170*61*71mm, fixing distance 965mm

>0.9

## Driver data Sheet

Driver data	DIM
Input rated Voltage	AC220-240V
Frequency	50/60Hz
Input Voltage	200-240VAC
Efficiency	91.5%
Total load Wattage	MAX. 39.9W
Power Factor	>0.95
Rated input current	<0.225A
Full load output Voltage	54-114VDC
Rated output current	200/250/300/350mA
Output current range	200/250/300/350±15mA
Power tolerance	±5%
Current output tolerance	±15mA
Withstand voltage	1750V
Short circuit protection	PASS
Overload protection	PASS
No-load protection	PASS

## Fixture Compatibility

Rated Wattage	Electrical Classification	Ingress Protection	Operating Temp	Operating Humidity	Storage Temp
Max.37W	I	IP20	-20°C-45°C	10-90%	-40°C-80°C

## Spectral Distribution

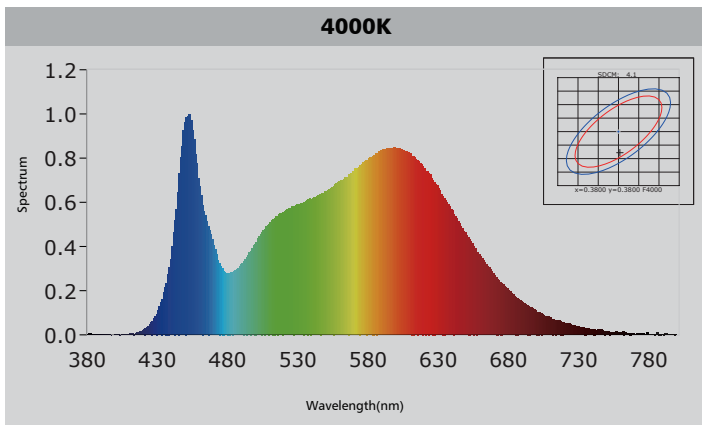
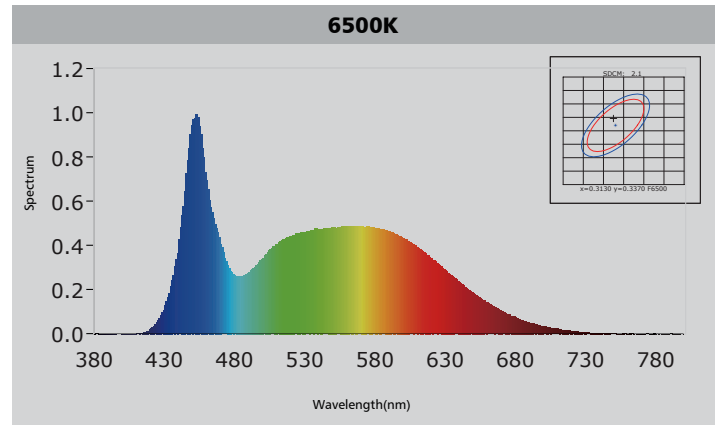
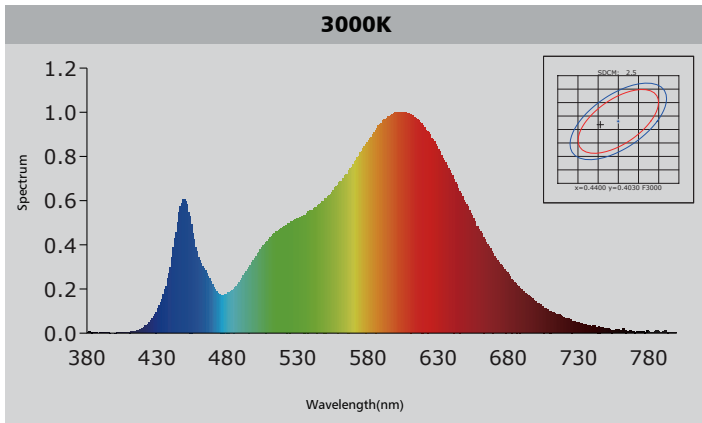

## Photometric Diagram

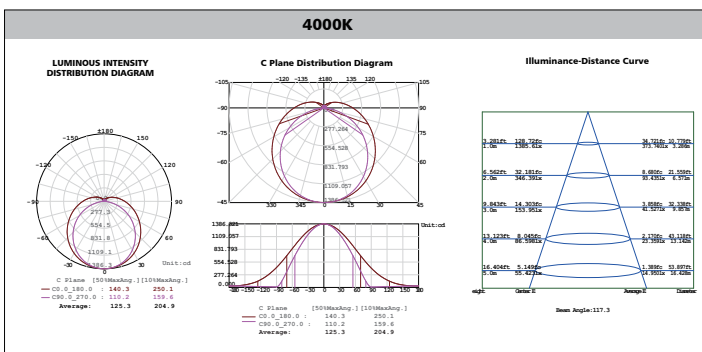
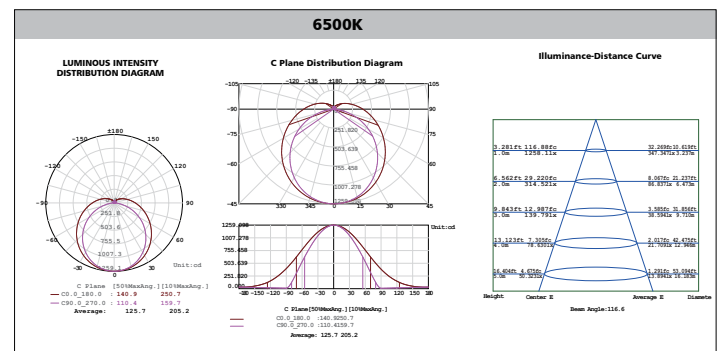
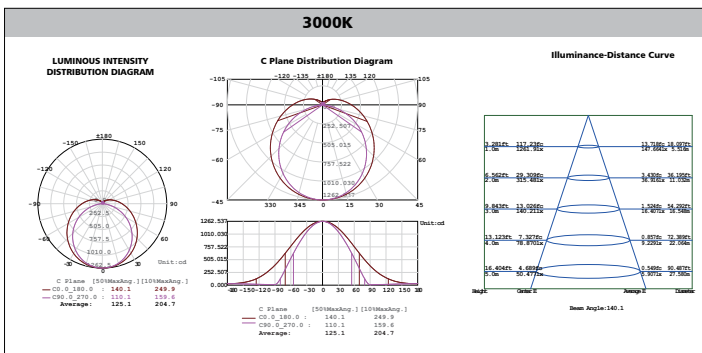

## Polar Diagram Comparison

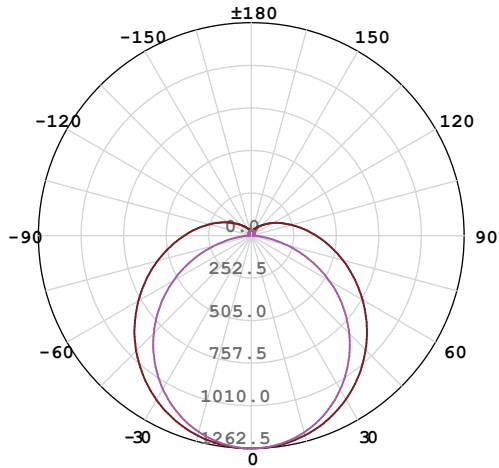

Unit:cd

C Plane [50%MaxAng.][10%MaxAng.]

— C0.0\_180.0: 140.1 249.9

— C90.0\_270.0: 110.1 159.6

Average: 125.1 204.7



## Average Lumen Maintenance and Chromaticity Shift VS. Time

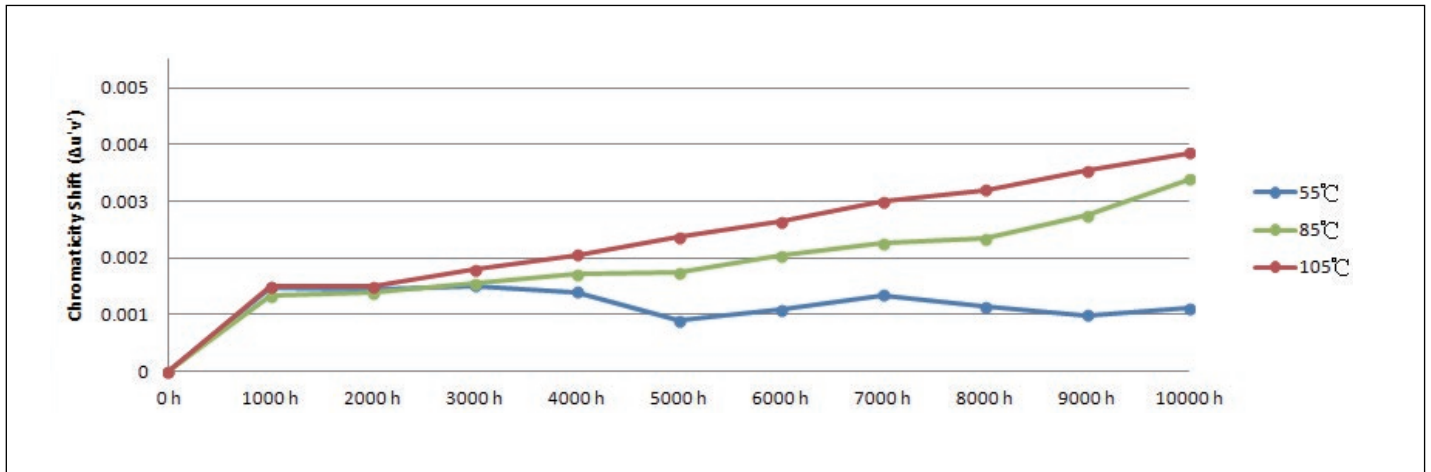

## Installation

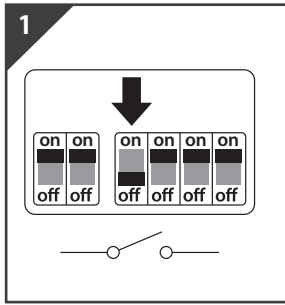

**1**  
Switch OFF at mains supply before installing

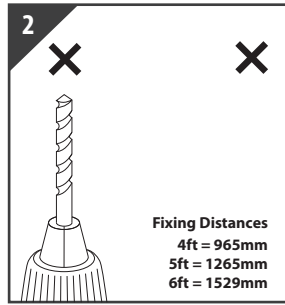

**2**  
Drill holes to the required distance and install plugs

Fixing Distances  
4ft = 965mm  
5ft = 1265mm  
6ft = 1529mm

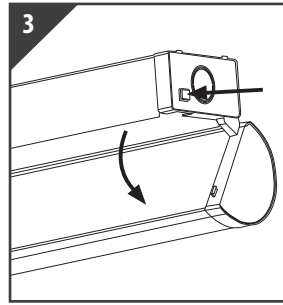

**3**  
Push button on end-cap and pull open casing

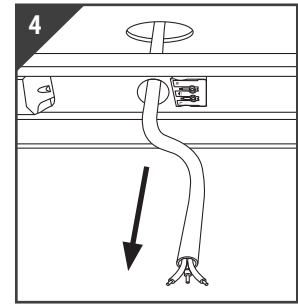

**4**  
Pull cable from ceiling through hole in batten

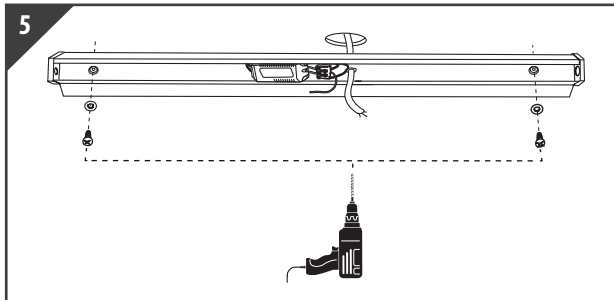

**5**  
Drill screws into previously installed plugs

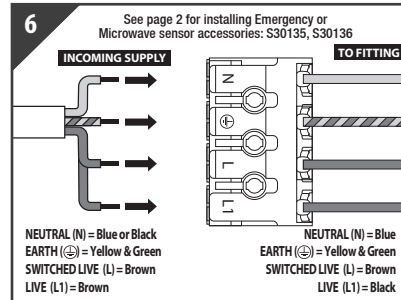

Push down the terminal, insert correct supply (as above) into terminal block, for the emergency unit to work correctly please ensure that an uninterrupted permanent live feed is present and is connected directly to the (L1) "Permanent Live" terminal of the connector block. Release the push fit terminal to secure.

Note: Please ensure there are no switches, PIRS etc in the permanent live feed, as switching of the emergency pack will reduce the battery's life considerably.

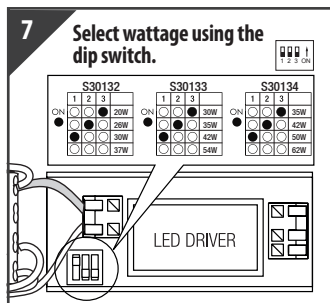

**7**  
Select wattage using the dip switch.

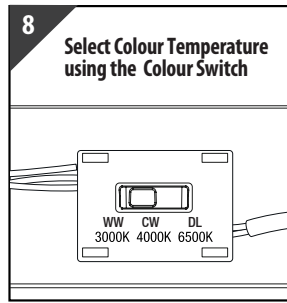

**8**  
Select Colour Temperature using the Colour Switch

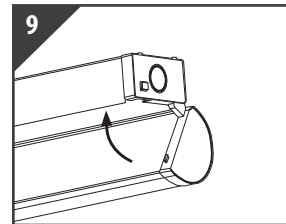

**9**  
Close casing ensuring it clicks into place

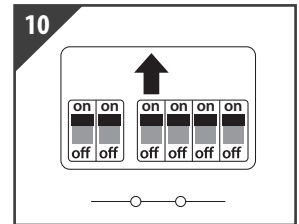

**10**  
Return power. Switch ON at mains supply

## Packaging Information

	SIZE(CM)	N.W/pc (KGS)	G.W.(KGS)	Q'TY(PCS)
Carton	119*35*16.5	1.25	16.5	10

	CTNS	Q'TY(PCS)	VOLUME(CBM)
20" standard container	405	4050	27.95
40" standard container	840	8400	57.96

